

# EOS 5D Mark II

## Pocket Guide

This quick guide explains basic function settings and how to shoot and playback images. You can take this guide with you for shooting. For detailed instructions, refer to the EOS 5D Mark II Instruction Manual.

This quick guide is for the EOS 5D Mark II installed with firmware Version 2.0.0 or later.



English Edition  
© CANON INC. 2010

### Quick Start Guide

- Insert the battery.
- Attach the lens. Align the red dot.
- Set the lens focus mode switch to <AF>.
- Open the cover and insert a CF card.
- Set the power switch to <ON>.

- Set the Mode Dial to <□> (Full Auto). All the necessary camera settings will be set automatically.
- Focus the subject. Aim the AF point over the subject and press the shutter button halfway to autofocus.
- Take the picture. Press the shutter button completely to take the picture.
- View the image. The captured image will be displayed for about 2 sec. on the LCD monitor.

- The ☆ on the right of the function indicates that the function is available only when the Mode Dial is set to **P**, **Tv**, **Av**, **M**, or **B**.
- Battery Life**

Temperature	At 23°C / 73°F	At 0°C / 32°F
Possible shots	Approx. 850 shots	Approx. 750 shots

### Image Playback

Playback Erase

INFO. Shooting information

Index Magnify

Select image

### Preparation

### Menu Operations

- Press the <MENU> button to display the menu.
- Turn the <MAIN DIAL> to select the tab, then turn the <QUICK CONTROL DIAL> to select the desired item.
- Press <SET> to display the setting.
- After setting the item, press <SET>.

### Fully-Automatic Modes (□/CA)

**P/Tv/Av/M/B Modes**

Menu items    Menu settings

### Menu Settings

#### Shooting 1

- Quality
- Beep
- Shoot w/o card
- Review time
- Peripheral illumin. correct.

#### Shooting 2

- Expo.comp./AEB
- White balance
- Custom WB
- WB SHIFT/BKT
- Color space
- Picture Style
- Dust Delete Data

#### Playback 1

- Protect images
- Rotate
- Erase images
- Print order
- Transfer order

#### Playback 2

- Highlight alert
- AF point disp.
- Histogram
- Slide show
- Image jump w/

#### Set-up 1

- Auto power off
- Auto rotate
- Format
- File numbering
- Select folder

#### Set-up 2

- LCD brightness
- Date/Time
- Language
- Video system
- Sensor cleaning
- Live View/Movie func. set.

#### Set-up 3

- Battery info.
- INFO. button
- External Speedlite control
- Camera user setting
- Clear settings
- Firmware Ver. 2.0.0

#### Custom Functions

- C.Fn I: Exposure
- C.Fn II: Image
- C.Fn III: Autofocus/Drive
- C.Fn IV: Operation/Others
- Clear all Custom Func. (C.Fn)

### Quick Control Screen

- Press <QUICK CONTROL DIAL> straight down. The Quick Control screen will appear.
- Tilt the <QUICK CONTROL DIAL> to select the function, then turn the <MAIN DIAL> or <QUICK CONTROL DIAL> to set it.
- In the fully-automatic modes (□/CA), you can select certain drive modes and the image-recording quality.

### Image-recording Quality

- Select <QUALITY>.
- Turn the <MAIN DIAL> or <QUICK CONTROL DIAL> to select the quality and press <SET>.

Image-recording quality

Quality

RAW

JPEG

Possible shots

RAW: Turn the <MAIN DIAL> dial to select the quality.

JPEG: Turn the <QUICK CONTROL DIAL> dial to select the quality.

### Picture Style ☆

- Press the <PICTURE STYLE> button.
- Turn the <MAIN DIAL> or <QUICK CONTROL DIAL> to select the Picture Style.

Style	Description
Standard	Vivid colors and sharp images.
Portrait	Nice skin tones and slightly sharp images.
Landscape	Vivid blue skies and greenery and very sharp images.
Monochrome	Black-and-white images.

- For <Neutral> and <Faithful>, see the camera's instruction manual.

# Shooting Operation

## Nomenclature

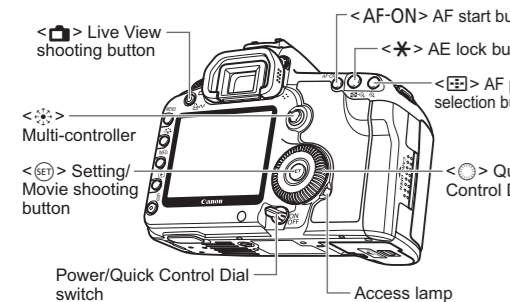
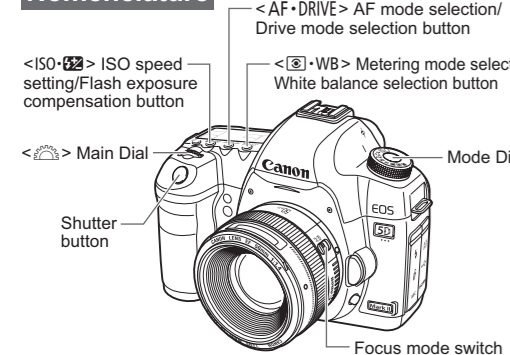

## LCD Panel

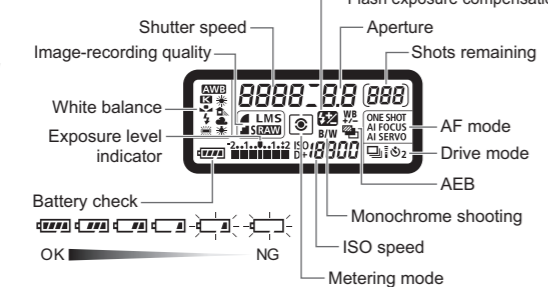

## Viewfinder Information

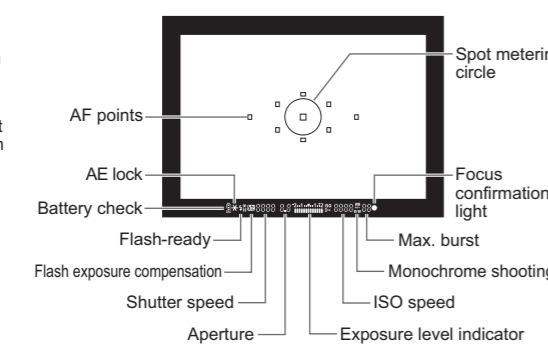

## Fully-Automatic Modes ( / CA)

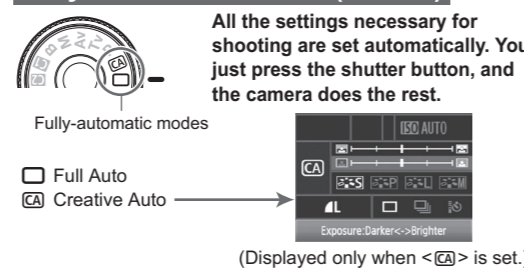

- Press < > straight down, then tilt < > to select the function.
- Turn the < > or < > dial to set the function.

## P/Tv/Av/M Modes

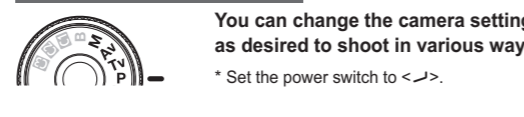

- Set the Mode Dial to < P >.
- As with the < > mode, when focus is achieved, the shutter speed and aperture will be automatically set.

## Tv: Shutter-priority AE

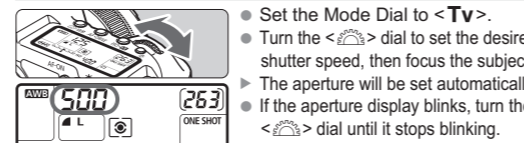

- Set the Mode Dial to < Tv >.
- Turn the < > dial to set the desired shutter speed, then focus the subject.
- The aperture will be set automatically.
- If the aperture display blinks, turn the < > dial until it stops blinking.

## Av: Aperture-priority AE

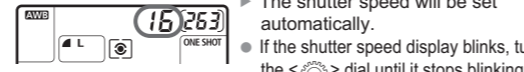

- Set the Mode Dial to < Av >.
- Turn the < > dial to set the desired aperture, then focus the subject.
- The shutter speed will be set automatically.
- If the shutter speed display blinks, turn the < > dial until it stops blinking.

## M: Manual Exposure

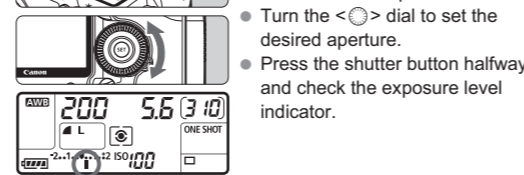

- Set the Mode Dial to < M >.
- Turn the < > dial to set the desired shutter speed.
- Turn the < > dial to set the desired aperture.
- Press the shutter button halfway and check the exposure level indicator.

## AF: AF Mode \*

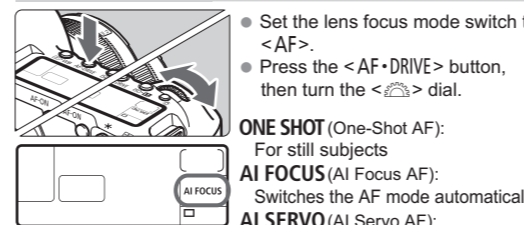

- Set the lens focus mode switch to < AF >.
- Press the < AF-DRIVE > button, then turn the < > dial.

**ONE SHOT (One-Shot AF):** For still subjects  
**AI FOCUS (AI Focus AF):** Switches the AF mode automatically  
**AI SERVO (AI Servo AF):** For moving subjects

## AF Point \*

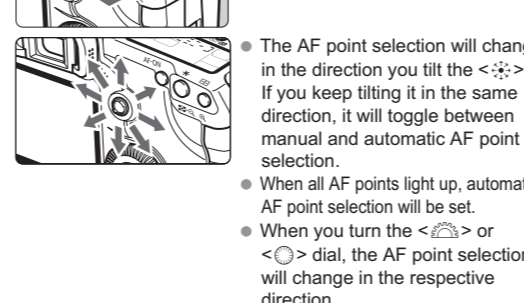

- Press the < > button, then look through the viewfinder.
- The AF point selection will change in the direction you tilt the < >. If you keep tilting it in the same direction, it will toggle between manual and automatic AF point selection.
- When all AF points light up, automatic AF point selection will be set.
- When you turn the < > or < > dial, the AF point selection will change in the respective direction.

## ISO: ISO Speed \*

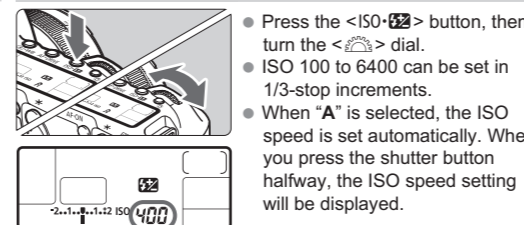

- Press the < ISO > button, then turn the < > dial.
- ISO 100 to 6400 can be set in 1/3-stop increments.
- When "A" is selected, the ISO speed is set automatically. When you press the shutter button halfway, the ISO speed setting will be displayed.

## Drive Mode \*

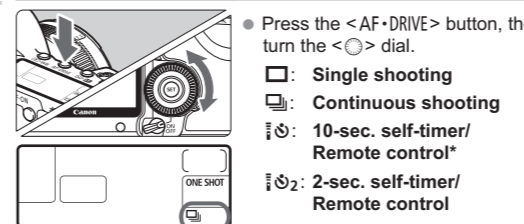

- Press the < AF-DRIVE > button, then turn the < > dial.
- Single shooting**
- Continuous shooting**
- 10-sec. self-timer/Remote control\***
- 2-sec. self-timer/Remote control**

\* This drive mode < > can be set in all shooting modes.

## Live View Shooting/Movie Shooting

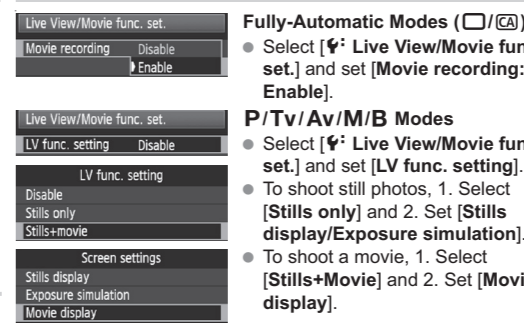

- Press the < > button to display the Live View image.
- Press the < AF-ON > button to focus the subject.
- Press the shutter button completely to take a still photo.
- If [Movie recording: Enable] or [Stills+movie] is set, press < SET > to start shooting a movie. To stop shooting the movie, press < SET > again.
- While shooting a movie, you can also take a still photo by pressing the shutter button.

# Custom Functions

## C.Fn I: Exposure

- Exposure level increments
- ISO speed setting increments
- ISO expansion
- Bracketing auto cancel
- Bracketing sequence
- Safety shift
- Flash sync. speed in Av mode

## C.Fn II: Image

- Long exposure noise reduction
- High ISO speed noise reduction
- Highlight tone priority
- Auto Lighting Optimizer

## C.Fn III: Autofocus/Drive

- Lens drive when AF impossible
- Lens AF stop button function

- AF point selection method
- Superimposed display
- AF-assist beam firing
- Mirror lockup
- AF point area expansion
- AF Microadjustment

## C.Fn IV: Operation/Others

- Shutter button/AF-ON button
- AF-ON/AE lock button switch
- Assign SET button
- Dial direction during Tv/Av
- Focusing screen
- Add original decision data